

ARX 605 User Reference Manual



SPECIFICATIONS

Model No	ARX605
Backplane	5-slot 64-bit/ 66 MHz 6U cPCI CT bus backplane PICMG 2.5H. 110CT bus
cPCI Standards	2.0 R3.0, 2.1 R2.0, 2.5 R1.0
Form Factor	6U CompactPCI
Accessible Slots	1 system slot & 4 Peripheral slots
Rear I/O	P3 & P5 rear I/O
Display	15", 1024x 768 TFT LCD Monitor with touch screen
Drive bay	One slim DVD-ROM
KB/MS	Integrated keyboard and touchpad, RJ-45 connector Operating Life of Keys: 8 million cycles Keyboard Layout: CH, FR, GR, KR, RU, SP, UK, US
Power Supply	1U, 400W, 100~240VAC Power supply, Auto switch
Construction	Rugged Aluminum Construction with shock absorbing rubber corners
Dimension	422Wx 285Hx 227D mm
Weight	12 kgs
Carrying Case	Padded carrying case with wheels

ENVIRONMENTAL FACTORS

	Operating	Non-Operating
Temperature	0°C~50°C	-20°C~60°C
Relative Humidity	10%~90%	10%~95%
Approval	CE, FCC, RoHS	

Standard Accessory Kits

ARX 605			
Model	Accessory Kit SKD		Qty
ARX605	1	ARX605 Portable Computer Chassis	1
	2	Carrying Case with wheels	1
	3	User's Manual	1
	4	Power Cord	1
	5	VGA to VGA cable (180mm)	1
	6	DVI-D to DVI-D cable (180mm)	1
	7	USB to USB cable (180mm)	1
	8	Anti-Static Bag	1
	9		



Carrying Case with Wheels

ARX 605 features:

- Designed for portable instrument applications
- 6U compactPCI and PICNG 2.5 H.110 CT Bus
- PICMG 2.1 Hot Swap compliant 32-bit or 64-bit 5-slot CompactPCI backplane with P3 & P5 rear IO
- Built-in 15" LCD display with touch screen, 1024x 768, 16.2M, 250 nits brightness
- One system slot and 4 peripheral slots
- Aluminum Alloy Housing design
- Integrated keyboard and touchpad
- 1U 400W power supply, 100~240VAC
- Built-in slim DVD-ROM device
- Carrying case to manage portable PC with ease

The ARX605 is a 5-slot 6U Compact PCI portable computer chassis. It supports one system slot and 4 Compact PCI Peripheral slots. The ARX605 provides 15" high brightness TFT LCD display with touch screen, allows users to fully enjoy the beauty of true colors and easy to control, and integrates foldable 87 keys multi-languages keyboard and touchpad. It is a powerful and versatile portable solution that allows users develop the test and measurement applications, and capable of a wide range of applications, such as power industry applications, military applications, and telecommunication applications.

2.0 Operation

1. Releasing Keyboard from main unit by pushing up the 2 taps located on both side of the chassis to release the locking mechanism, and then pull out the keyboard.

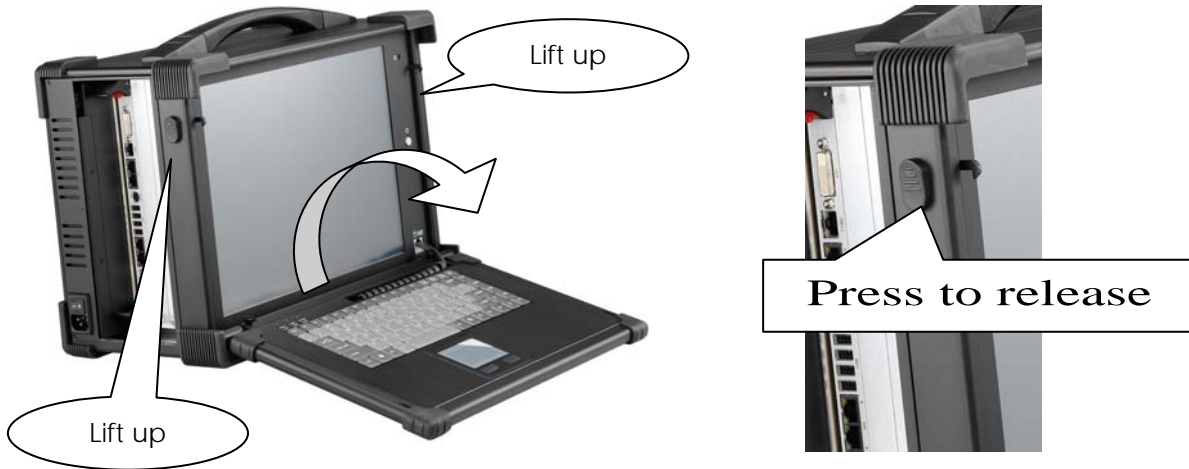

2. You have the option of leaving the keyboard attached to the chassis or they can be release independently from the chassis by pushing the two levers inward to release the lock.

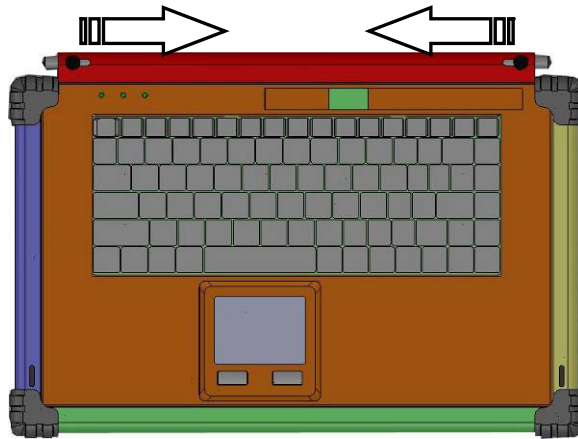

3. Connect the RJ-45 keyboard/touchpad cable to the front bottom right corner of the chassis. Make sure the pin direction is correct when inserting.



4. You can flip the 2 feet located underneath the chassis outward to help create an angle for the chassis for viewing comfort.

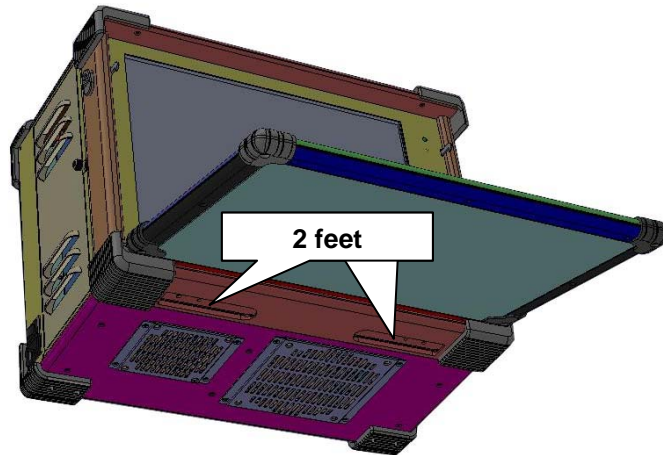

5. Access the available 1 system slot for 6U CompactPCI controller and 4 peripheral slots on the right side of the chassis.

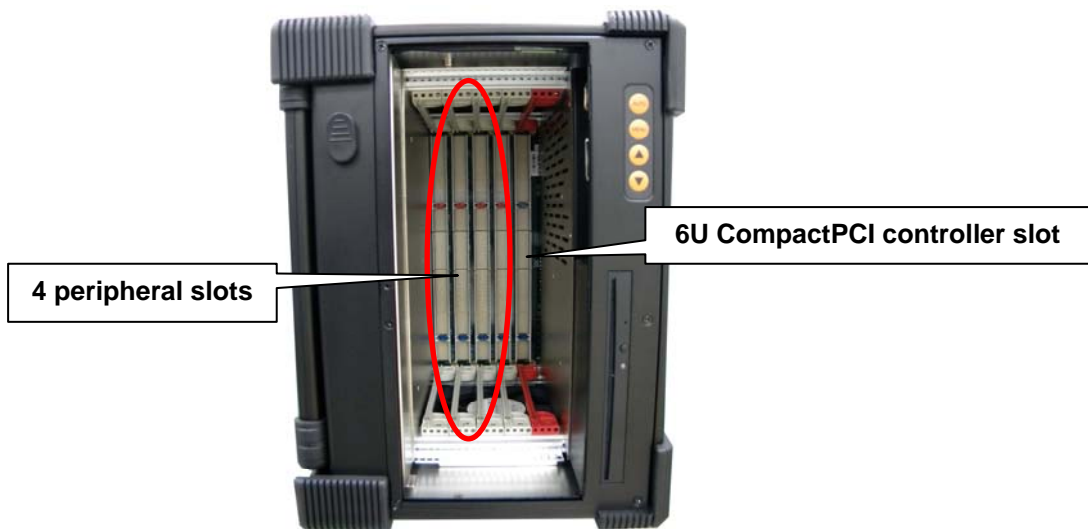

6. There are USB, DVI-D and VGA connectors on the right side of the system slot



7. Connect the ARX605 USB connector to CPU controller USB port
Connect the ARX605 VGA or DVI-D connector to CPU controller VGA or DVI-D port

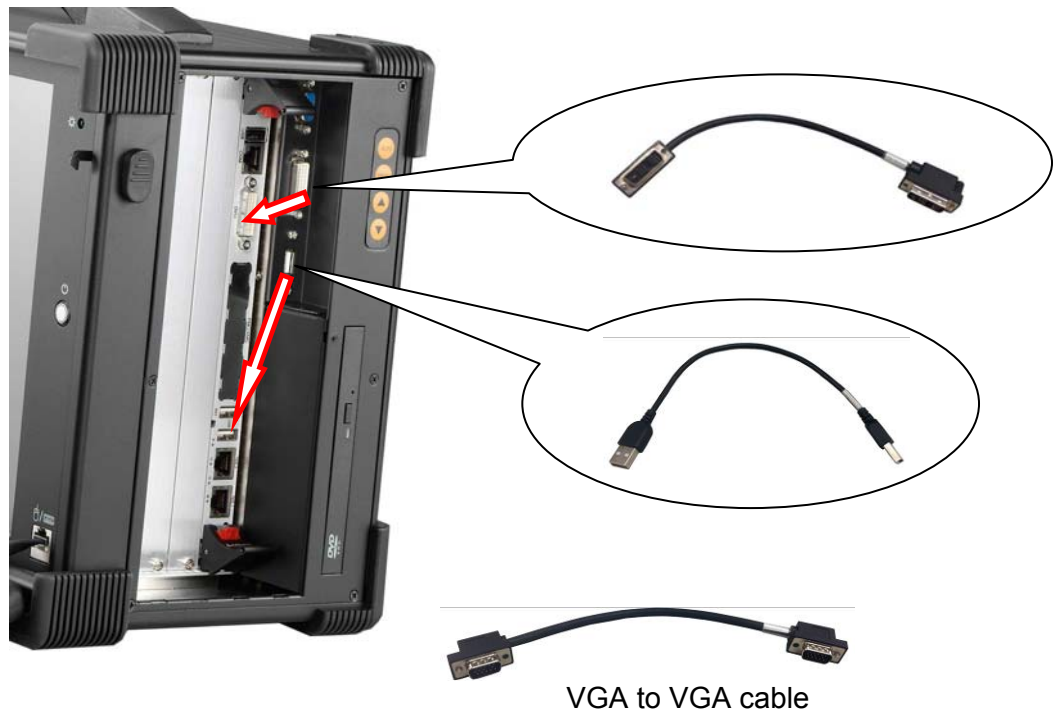

8. Connect the power cable into the power supply unit



9. Press the power switch located on the front panel of the chassis to power up the unit.
There have indicator LED lights for Power and LCD OSD and DVD-ROM in the right side



10. Keyboard and touchpad surface act as input for the system.

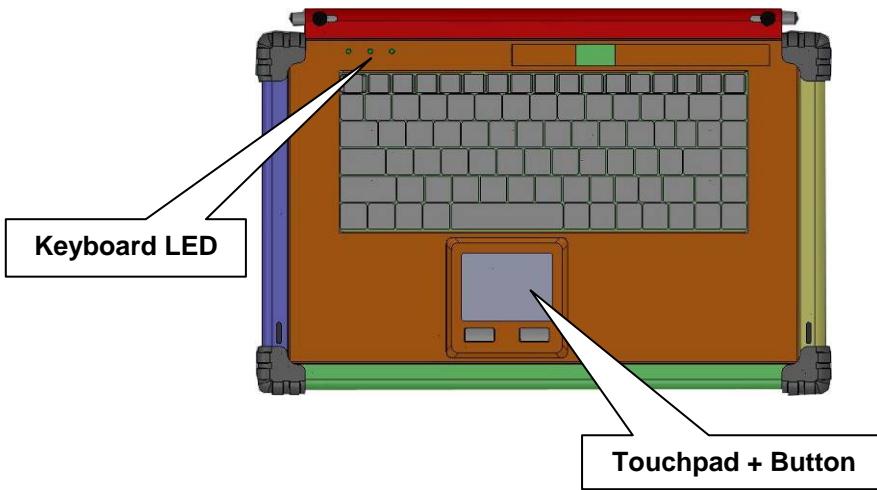

11. Close the left side and right side dust cover to protect the ARX605 system.

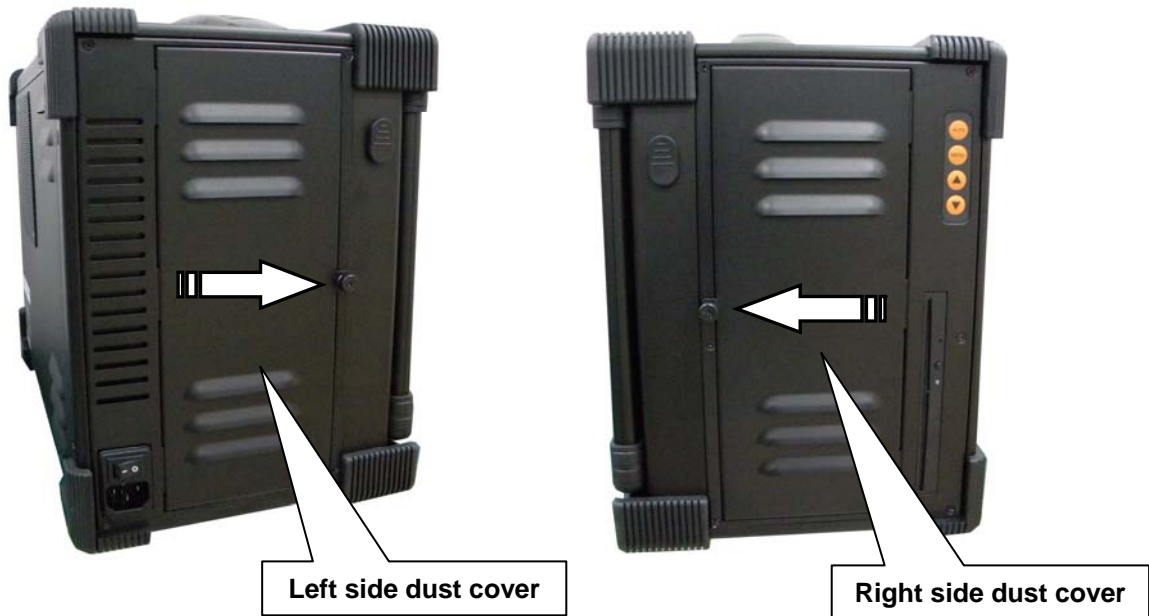

3.0 Troubleshooting

1. Installation problem:

1. Normally problem with a fail start up is due to installation problem.
2. Double check all the peripheral cards or items you have added to the ARX.
3. Are all the items seated properly?
4. Are all the cables connected back to its original or correct position?
5. Are the items you have added compatible?
6. Before you check for these, turn the computer off and unplug the power cord.
7. Check for 1 thru 5 and then re-power up the computer.
8. Remove all items that were added and re-try system power up.
9. If the system starts now, try inserting 1 new item in at a time and try powering up.
10. Repeat this step until you get the desired result.

2. System Fails to power up:

1. Check you power connection first.
2. Check the main power switch is in the ON positions (I) *If cold switch is available.
3. Press the power button located on the machine.

3. No display (LCD):

1. Check all the proper power up procedure has been taken.
2. Hook up an external LCD to the VGA port, to check if video is present.
3. If video is present on external LCD, check the internal LCD cable connection.
4. Or check your VGA setting to make sure LCD video is enabled.
5. If there is no video on external, check your system to make sure everything is seated properly.
6. If everything is seated properly and still no video, call us for further assistance.

4. External LCD no display:

1. Check to see if you have internal LCD video.
2. Check if your LCD is functioning properly.
3. Check your VGA setting to make sure external video is enabled.