

ARL 945/ ARL945-B User Reference Manual



SPECIFICATIONS

Model No	ARL945	ARL945-B
CPU	Intel Core 2 Duo T7500, 2.2GHz Processors (Option: Intel Core 2 Duo T9400, 2.53 GHz)	
Chipset	Intel Gm45 Chipset + ICH9M	
Slot	2 PCI full-length expansion slots	
Display	17.3" TFT LCD Monitor, 1920x 1080, 262K colors, Anti-reflection tempered strengthen glass	
VGA	LVDS, GM45 chipset built-in	
Memory	2x 2GB RAM	
HDD	1x 500GB 2.5", 7200 rpm SATA HDD, support 1x 2.5" removable SATA	
CDROM	1x Slim DVD-RW	
Interfaces	PS/2 keyboard and mouse, 4x USB, Dual RJ-45 Gigabit LAN 2x COM Port, VGA CRT, audio (3x2)	
LAN	Dual Intel Gigabit LAN	
Audio	ICH9M built-in audio HD audio w/ Realtek ALC888 codec	
Speaker	Built-in amplified 2x 3W speakers	
KB/MS	Industrial keyboard with touchpad Keyboard layout: CH, FR, GR, KR, RU, SP, UK, US	
Power Supply	250W, 100~240 VAC, Auto switch	2x 95W Li-ION battery Packs (Hot-Swappable), 100W AC Adapter, up to 4 hours battery life
Construction	Rugged Aluminum Construction with shock absorbing rubber corners	
Dimension	428.6x 100.5x 367.5 mm (Wx Hx D)	
Weight	6.8 kgs	
Carrying Case	Padded carrying case with wheels	

ENVIRONMENTAL FACTORS

	Operating	Non-Operating
Temperature	0°C~50°C	-20°C~60°C
Relative Humidity	10%~90%	10%~95%
Approval	CE, FCC, RoHS	

OPTIONS

Power Supply		
		ARL945: 250W, 100~240 VAC, Auto switch
		ARL945-B: 2x 95W Li-ION battery Packs (Hot-Swappable)
Processor		
	•	Intel Core 2 Duo T7500 (4M Cache, 2.20 GHz, 800 MHz FSB) Processors
		Intel Core 2 Duo T9400 (6M Cache, 2.53 GHz, 1066 MHz FSB) Processors

Standard Accessory Kits

ARL945 / ARL945-B			
Model	Accessory Kit SKD		Qty
ARL945	1	ARL945 Portable Computer system	1
	2	Carrying Case with wheels	1
	3	Driver CD	1
	4	User's Manual	1
	5	Power Cord	1
	6	Anti-Static Bag	1
	7	Screw Pack (stabilizer)	1
	8	Stabilizer Supports Pack	1
	9		



Carrying Case with Wheels

ARL945/ ARL945-B features:

- All-in-one design rugged laptop
- Rugged Aluminum Construction with shock absorbing rubber corners
- Compact Size Lightweight Design
- Built-in 17.3" TFT LCD display, 1920x 1080 with anti-reflection tempered glass
- 250W PSU or 2x 95W Li-ion battery packs, up to 4 hours battery life
- Mini-ITX MB, Intel Core 2 Duo T7500 Processors
- Industrial Keyboard multi-language with touchpad
- 2 PCI full-length expansion slots
- Built-in 500GB HDD 7200 rpm, support 1x 2.5" removable SATA
- Dual Gigabit Ethernet Support
- Carrying case to manage portable PC with ease

The ARL945-B is a laptop-style multi-slot battery computing system with rugged aluminum chassis construction and corner bumper protection. It features the Intel Core 2 Duo processors with 2x 2G memory and built-in a 17.3" LCD display, 1920x 1080 resolution with anti-reflection tempered glass protection. The unit offers 2 PCI full-length expansion slots for latest high speed acquisition boards and integrates 500G SATA HDD, support a removable 2.5" SATA, 2x 3W speakers, 104-key multi-languages keyboard and touchpad. Interfacing with the unit takes place further with the built-in dual Gigabit Ethernet, Serial ports.

Dual high capacity Li-ion hot-swappable battery totaling 190WHr makes the ARL945-B ideal for critical application. It also can operate with 100W AC adapter for AC operation and recharging, and the LCD panel for battery capacity shows battery array fuel gauge, power, current, charge/ discharge state, time to fully charged and time to empty.

Applications: Military, Industrial automation, Digital TV test & analysis, Mobile Computing, Outdoor Computers, video conferencing, E-learning, Speech Technologies, Portable Workstation, Telemedicine, Multimedia, Mission Critical Computing



2.0 Internal Hardware Access

Be sure power cable is not connected to the system before proceeding

1. Unscrew the 4 thumb screws to remove the cover.



2. Remove the stabilizer bar

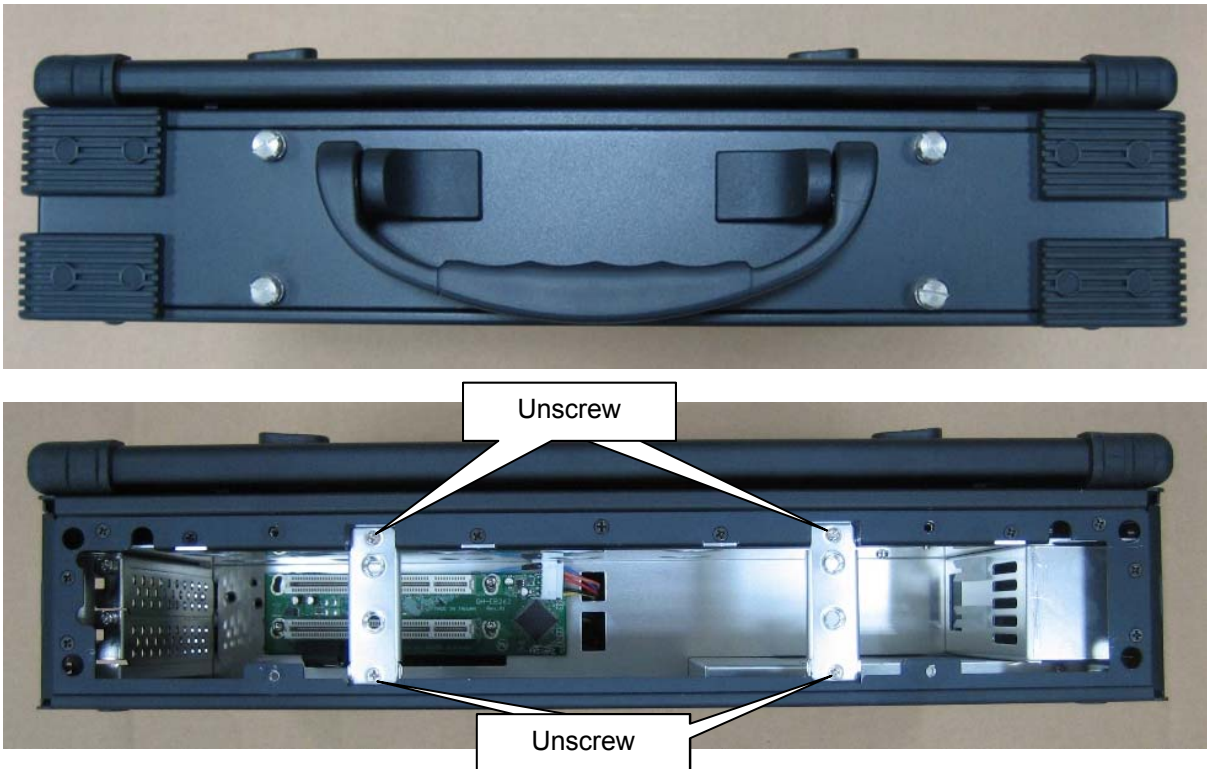

3. Install the add-in card.



3.0 Battery Pack (ARL945-B)

1. Battery Pack

The lithium ion battery pack is on the right side of the computer.

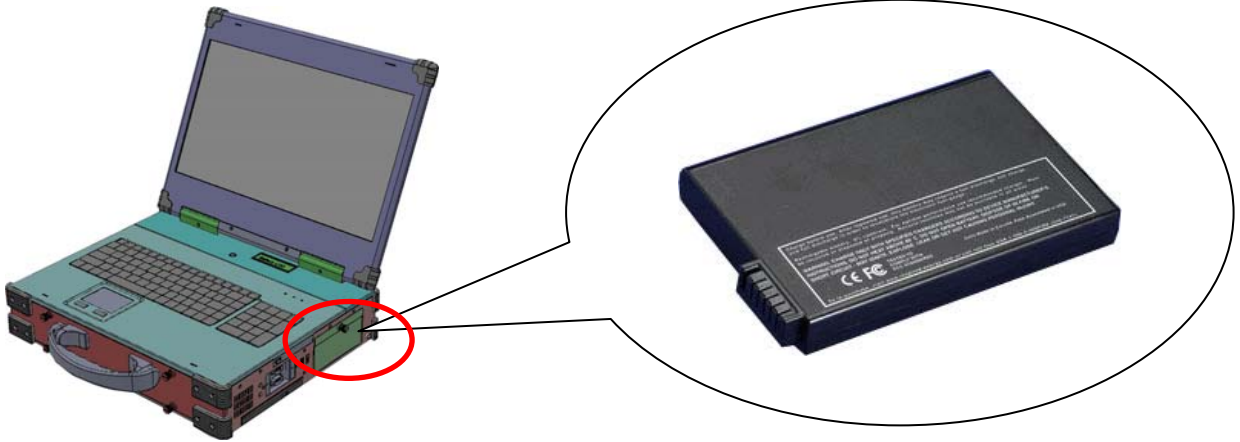

2. AC Operation / Battery Charging

Insert the adapter cord into the Power DC jack for recharging

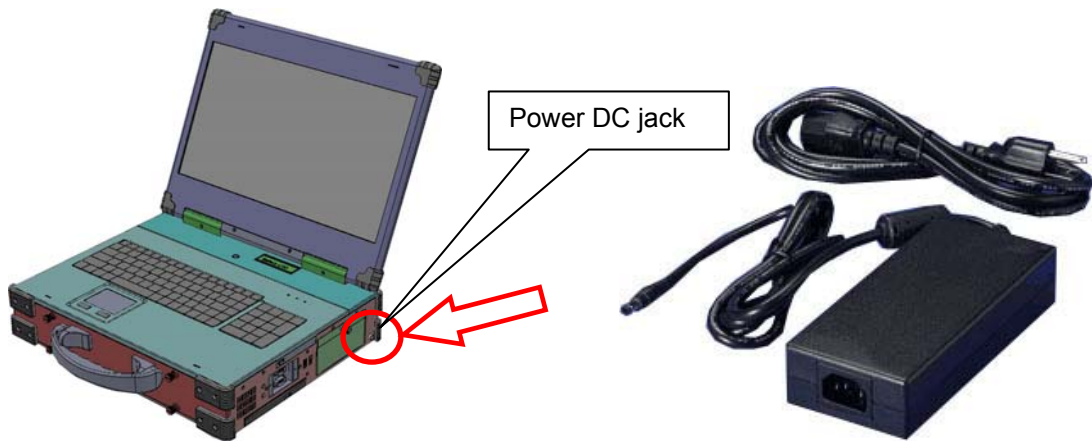

3. LCD panel for battery capacity

The LCD display shows battery array fuel gauge, power, current, charge/ discharge state, time to fully charged, time to empty.



4. Replacing the battery

4.1 Release the thumb screw of the battery cover

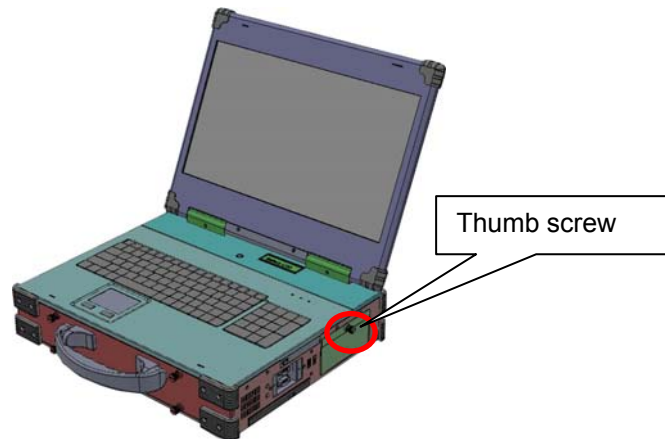

4.2 Pull out the battery connector from the slot



4.0 Software Installation

You can use the built-in DVD-RW to load operating system and additional applications software into the system. Available medium from USB or download can also be possible.

DOS Boot up: DOS boot up requires you to have a version of the DOS installed on hard disk drive or floppy. Depending on the execution sequence you have set in the batch file, you will usually get a DOS prompt after loading.

Window Boot up: Windows boot up requires you to have Windows installed in the hard disk drive. During Windows boot up, you will see a sequence of access to your hard disk drive which will eventually take you into a graphical user interface environment.

Other O/S description: Many other operating systems are available in the market, such as Linux, Windows, Solaris and DOS. These operating systems will behave differently and you should react accordingly.

5.0 Troubleshooting

1. Installation problem:

1. Normally problem with a fail start up is due to installation problem.
2. Double check all the peripheral cards or items you have added to the ARL.
3. Are all the items seated properly?
4. Are all the cables connected back to its original or correct position?
5. Are the items you have added compatible?
6. Before you check for these, turn the computer off and unplug the power cord.
7. Check for 1 thru 5 and then re-power up the computer.
8. Remove all items that were added and re-try system power up.
9. If the system starts now, try inserting 1 new item in at a time and try powering up.
10. Repeat this step until you get the desired result.

2. BIOS Beep Code:

The BIOS beep code indicates error in system initialization. The BIOS of the system board will associate with video and memory error. Please check your video card is properly seated and your memory is installed properly.

3. System Fails to power up:

1. Check you power connection first.
2. Check the main power switch is in the ON positions (I) *If cold switch is available.
3. Press the power button located on the machine.

4. No display (LCD):

1. Check all the proper power up procedure has been taken.
2. Hook up an external LCD to the VGA port, to check if video is present.
3. If video is present on external LCD, check the internal LCD cable connection.
4. Or check your VGA setting to make sure LCD video is enabled.
5. If there is no video on external, check your system to make sure everything is seated properly.
6. If everything is seated properly and still no video, call us for further assistance.

5. External LCD no display:

1. Check to see if you have internal LCD video.
2. Check if your LCD is functioning properly.
3. Check your VGA setting to make sure external video is enabled.

6. Keyboard fails:

1. Make sure the keyboard plug is inserted completely into the portable.
2. Make sure you do not have another keyboard connected to the side I/O PS/2 port.

7. TOUCHPAD fails:

1. Make sure the keyboard plug is inserted completely into the portable.
2. If you have an external PS/2 mouse hook up on the side I/O PS/2 port, the touch pad will not function simultaneously.
3. If your operating system requires and does not load the mouse driver automatically, make sure you have the proper mouse driver loaded.

8. DVD-RW fails:

1. Make sure the CD/DVD is readable.
2. If DVD-RW fails to be recognized during POST, check internal cable fit.